

**Acceptable slab on grade for pier supported manufactured home produced on or after April 1, 2007
[per SPS 321.40 (1)]**

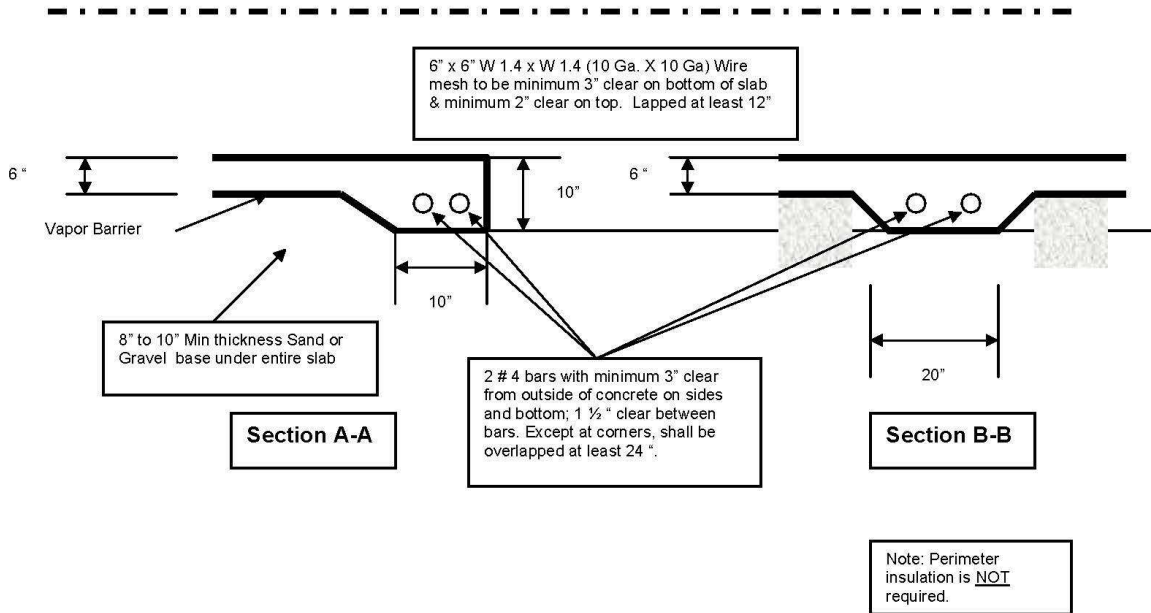
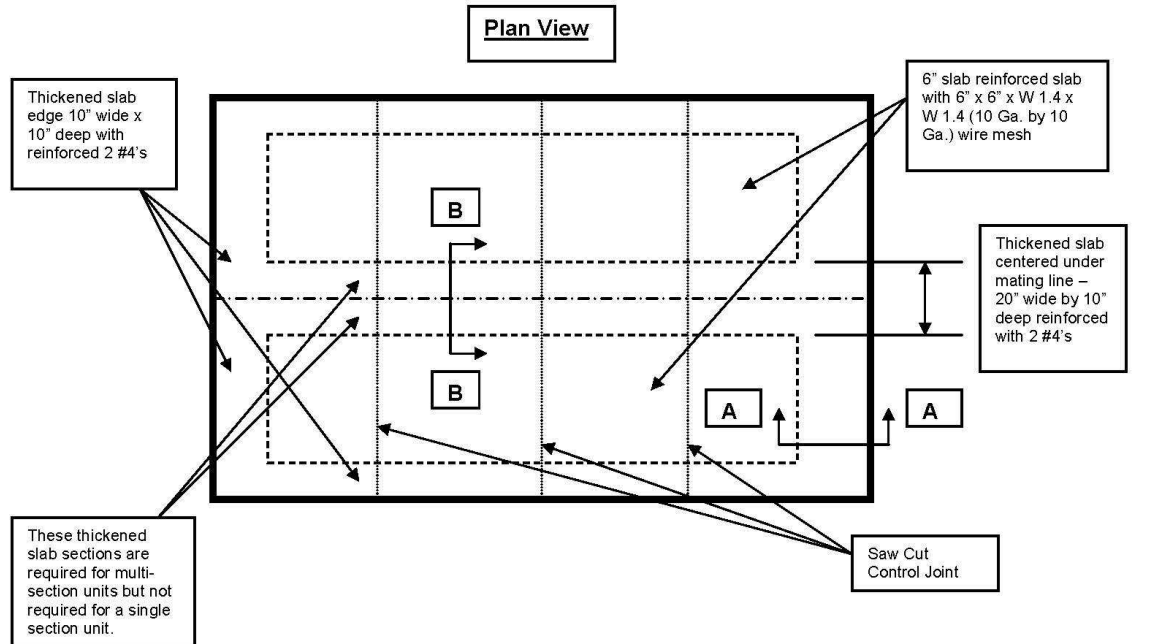

Limitations:

1. Minimum 3,000 psi concrete. [24 CFR 3285.312(a)(1)(ii)]
2. Rebar and mesh at least grade 40.
3. Soil bearing capacity at least 2,000 psf. [SPS 321.40 (2) (b) 2.]
4. Placed on undisturbed soil. May not be placed on unprepared fill material, organic soil, alluvial soil, mud, or frozen soil. [SPS 321.40 (2) (b) 1. and 24 CFR 3285.312(a)]